

# Canister boxes SF-CH

## Characteristics

- Application: Installation on contaminated air extraction networks, safe replacement of the filter in a plastic bag
- 20/10 steel welded
- Baked epoxy paint RAL 9010
- Tear-proof bag with integrated elastic
- Tightening of the filter by eccentric cams
- Maximum service temperature: 90°C

## Advantages

- Continuous welded
- Robust and modular
- Closing hatch with polarizing system, guaranteeing the correct installation of the filter
- Mechanical resistance +/-5000 Pa
- Qualified casing: Class D according to EN 12237, Class C according to Eurovent 2/2, L1 according to EN 1886
- Pressure taps with valves



Reference	Box dimensions (mm)				Filter dimensions (mm)			Weight (Kg)
	C	B	B dual version	A	L	W	H	
SF-CH BB	450	498	996	376	305	305	98	16,2
SF-CH BBL	450	498	996	428	305	305	150	19,8
SF-CH BBM	450	498	996	570	305	305	292	26,6
SF-CH BE	450	804	1608	376	305	610	98	20,6
SF-CH BEL	450	804	1608	428	305	610	150	24,2
SF-CH BEM	450	804	1608	570	305	610	292	31
SF-CH EB	755	498	996	376	610	305	98	27,4
SF-CH EBL	755	498	996	428	610	305	150	31
SF-CH EBM	755	498	996	570	610	305	292	37,8
SF-CH EE	755	804	1608	376	610	610	98	31,8
SF-CH EEL	755	804	1608	428	610	610	150	35,4
SF-CH EEM	755	804	1608	570	610	610	292	42,2
SF-CF/EEM-DUO	755	804	-	900	610	610	98 + 292	42,2
SF-CH EF	755	956	1912	376	610	762	98	36,8
SF-CH EFM	755	956	1912	570	610	762	292	44

## Options

- Horizontal airflow
- Upper/lower manifold - Support feet
- AISI 304 or AISI 316 stainless steel version
- ATEX version
- Built-in manual test scan. Global integrity check according to ISO 14644-3
- Double version with only one door
- Casing with integrated pre-filter DUO Version
- Integrated maintenance table
- Door with inspection window
- Pressure gauge with support
- Factory assembly or pre-assembly
- Individual test report according to EN12237 class D
- Scissors heat sealer

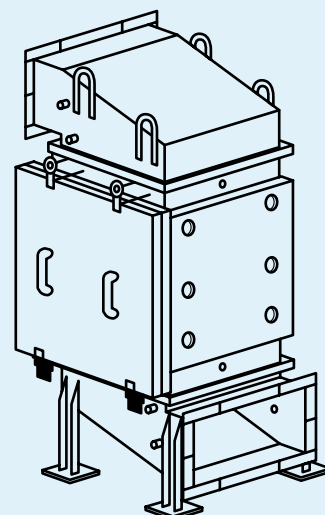

# Canister boxes SF-CH

## Single entry version

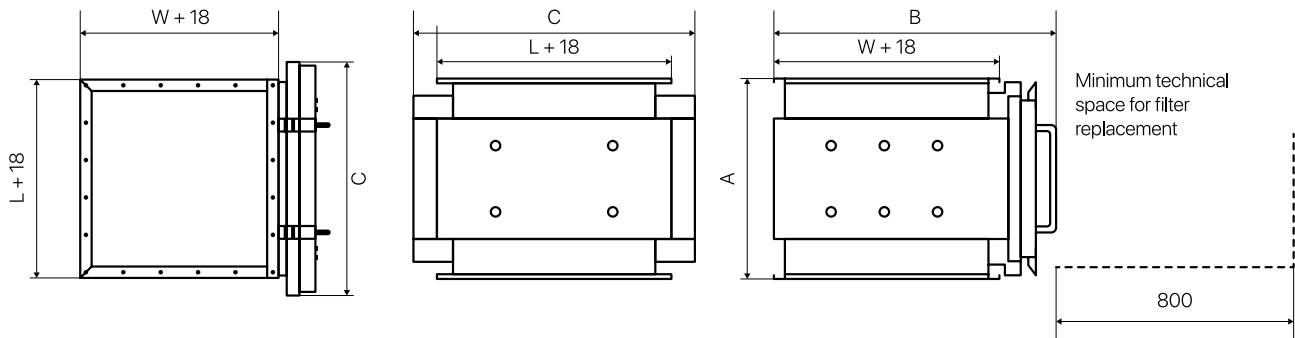

## Double entry version

Minimum technical space for filter replacement

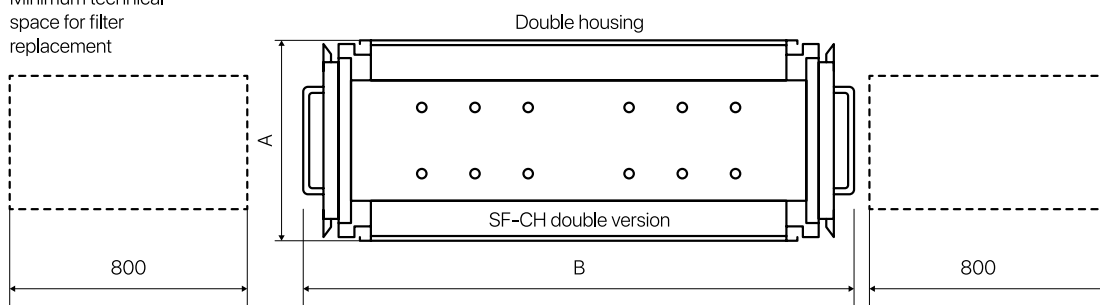

## Duo version

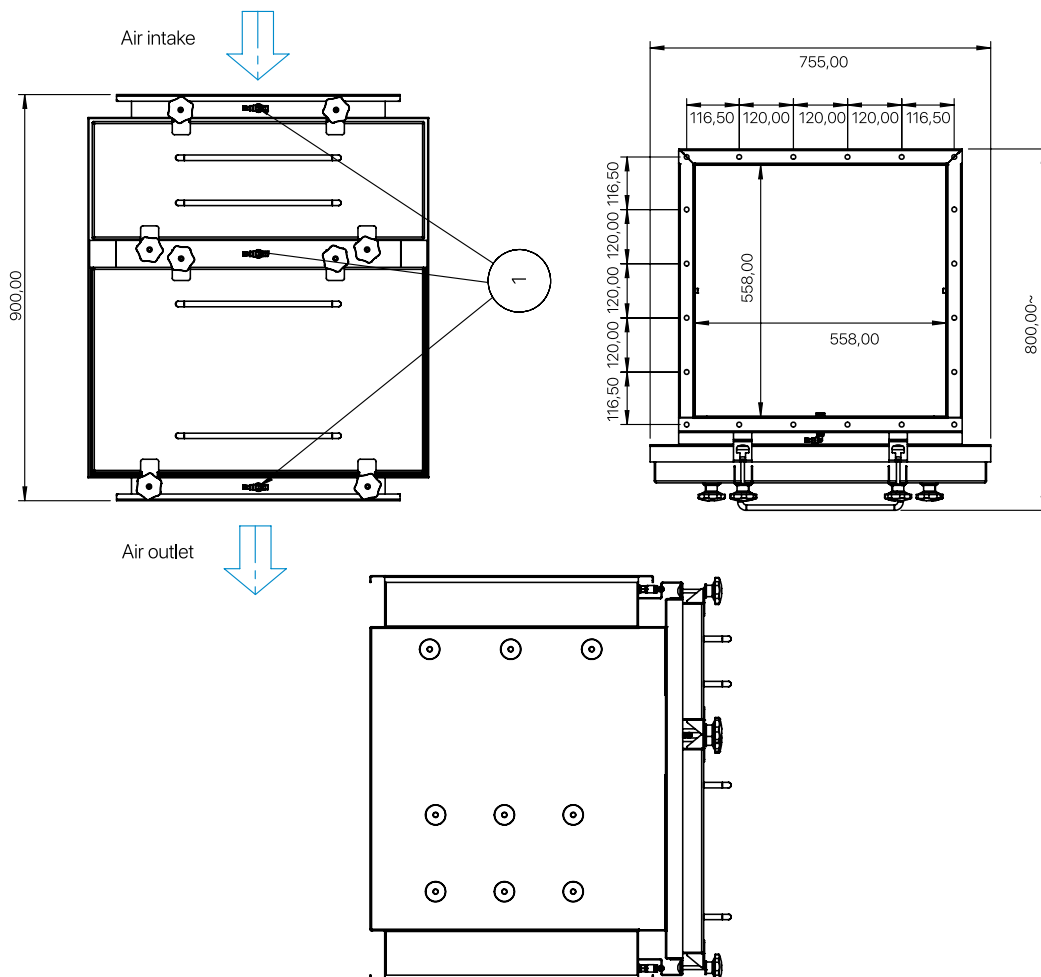

# Canister boxes SF-CH

## Single door drilling plan

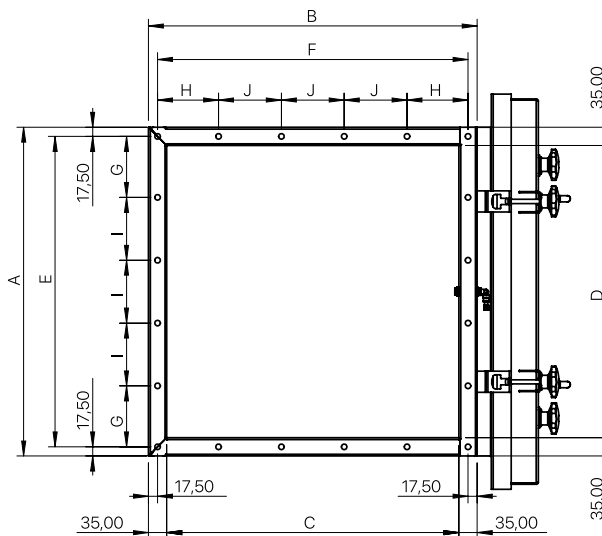

Reference	Dimensions in mm										No. of holes	
	A	B	C	D	E	F	G	H	I	J		
EEM												
EEL	628	628	558	558	593	593	116,5	116,5	120	120	20	
EE												
EBM												
EBL	628	323	253	558	593	288	116,5	96	120	96	16	
EB												
BEM												
BEL	323	628	558	253	288	593	96	116,5	96	120	16	
BE												
BBM												
BBL	323	323	253	253	288	288	96	96	96	96	12	
BB												
EFM												
EF	628	780	710	558	593	745	116,5	116,5	120	128	22	

## Double door drilling plan

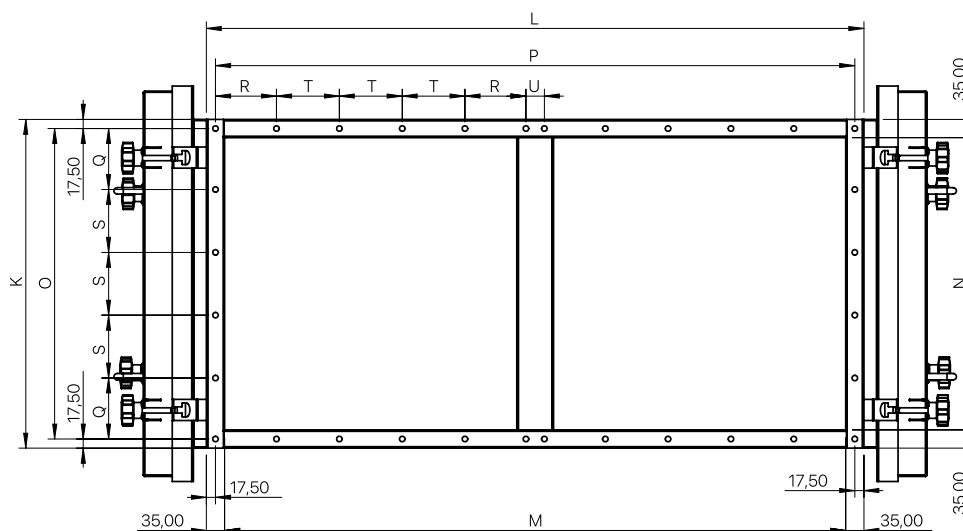

Reference	K	L	M	N	O	P	Q	R	S	T	U	No. of holes
EEM												
EEL	628	1256	1186	558	593	1221	116,5	116,5	120	120	35	20
EE												

# Canister boxes SF-CH



Standard version



ATEX version

## Standard version

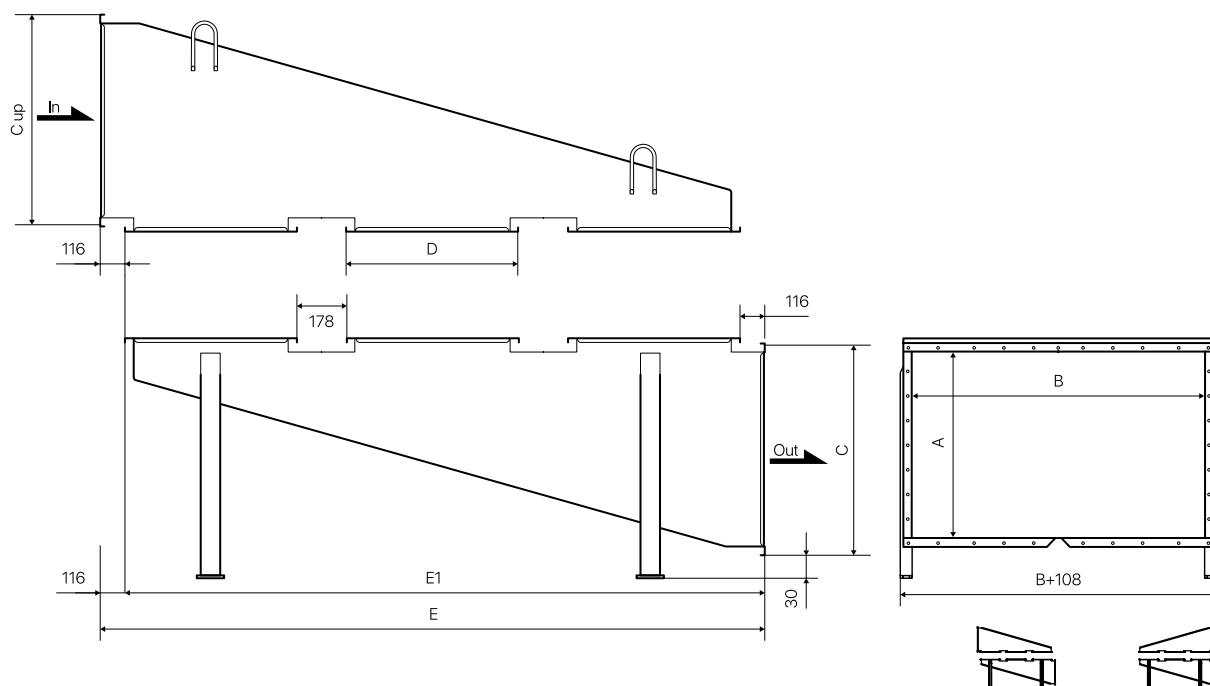

Number of enclosures	A	B	C	C up	D	E	E1
1	254	558	376	346	628	860	744
2	254	558	376	346	628	1666	1550
3	406	558	528	498	628	2472	2356
4	558	558	680	650	628	3278	3162
5	558	558	680	650	628	4084	3968
6	812	558	934	904	628	4890	4774
7	812	558	934	904	628	5696	5580
8	915	558	1037	1007	628	6502	6386

N.B.: the dimensions of the connectors apply to filter sizes 610x610 mm  
Check the air speed at the entrance/exit of the collectors, it must be < 10 m/s

# Filter replacement procedure

## Replace filter

### Replace filter

- Turn off the fan
- Close the registers upstream and/or downstream (if present)
- Level the pressure (if balance valve is present)
- Loosen the star knobs and remove the door
- Release the filters by turning the handles horizontally

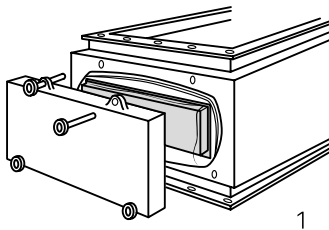

- Unroll the plastic bag
- Pull the filter into the plastic bag and place it on a flat surface or maintenance table

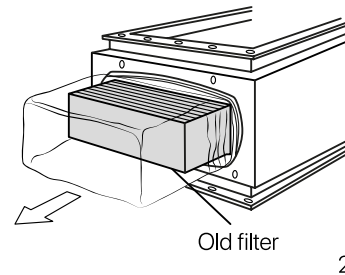

### Sealing the plastic bag

- Flatten the bag without creases
- Seal the bag with a thermal welding machine at 2 points and cut the bag between the 2 welds

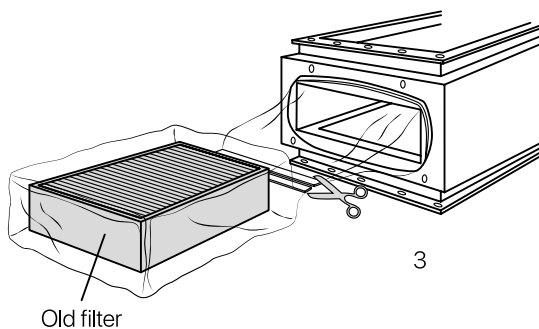

### Placing a new filter

- Place the filter in the bag with the seal facing up towards the air inlet
- Place the elastic of the new plastic bag over the groove around the opening of the housing

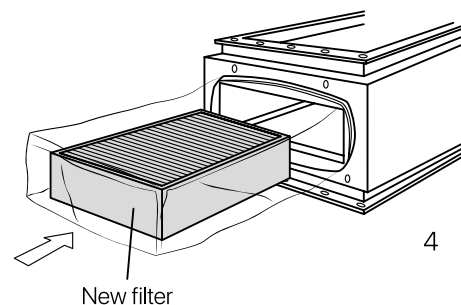

### Remove the rest of the old plastic bag

- Detach the remainder of the old bag from the housing and pull it into the recess provided in the new bag
- Slide the new filter into place in the housing without damaging the seal
- Use the lever system to tighten the filter
- Roll up the plastic bag with the remainder of the old bag and place it against the filter
- Replace the door and tighten the knobs

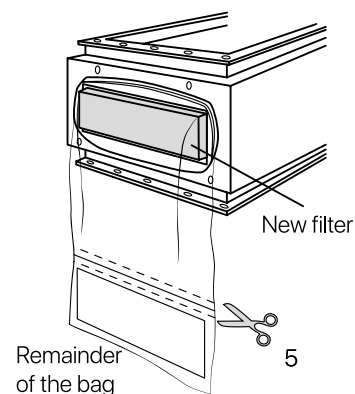

# Canister boxes SF-CH

Example of a configuration: SF-CH/EF M S G -

**1** **2** **3** **4** **5**

1-Dimensions	
BB	305x305
BE	305x610
EB	610x305
EE	610x610
EF	610x762

2-Filter depth	
-	98 mm
L	150 mm
M	292 mm

3-Version	
S	Single version
Bi-Side	Double version

4-Equipment	
G	Steel RAL 9010
S	AISI 304L
SS	AISI 316L

5-Option	
DUO	Filter 610*610*292 + 610*610*98 (48)